



- Ambient, no heat
- Electrical heat 3–15 kW
- Water heat

Lengths: 1, 1,5 and 2 metres



## Thermozone® AC 200

### Air curtains for entry doors up to 2,5 metres

AC200 is available with electrical heat or in the ambient form without heat. For water heated versions, visit [www.frico.se](http://www.frico.se).

AC200 air curtains are intended for permanent installation above smaller doors up to 2,5 metres high. Cold draught and energy losses through the opening are efficiently prevented. A good inside heating comfort is thereby obtained and the floor surface close to the opening becomes fully usable.

AC200 with heat contribute to the warming up of the rooms whereas models without heat are designed to prevent energy losses from air conditioned or cold room openings into heated spaces.

Thanks to a compact design and air intake through the front, AC200 units are easily mounted and require minimum headroom above the opening. They can also be mounted in false ceilings. In wide doorways, several units can be mounted next to each other and regulated with a common thermostat and control panel. Three different lengths make it possible to cover openings of different widths.

- Low sound level.
- Corrosion proof housing made of hot zinc-plate and powder enamelled steel panels. Colour: RAL 9016.
- Compact design requires minimum headroom
- Overheat protection resetable from outside the unit (⚡).
- Control panel can be internally mounted and be regulated externally.
- Easy connection of AC203C with cable and plug.

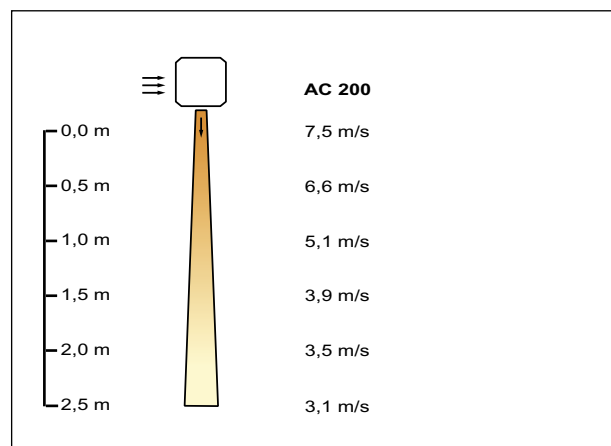

Approved by SEMKO and CE compliant.

#### Air velocity profile



Design and specifications are subject to change without notice.

**Technical specifications** | Thermozone AC 200 without heat \* 

Type	Output stages [kW]	Airflow [m³/h]	Sound level [dB(A)]	Voltage [V]	Amperage [A]	Length [mm]	Weight [kg]
AC201	0/ 	900/1200	42/51	230V~	0,4	985	13,4
AC202	0/ 	1400/1900	43/52	230V~	0,6	1500	18
AC202XL	0/ 	1800/2400	45/54	230V~	0,8	1945	28

\*) All ambient versions on demand

Protection class AC200 without heat: (IP44), splash-proof design.

**Technical specifications** | Thermozone AC 200 with electrical heat 

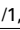
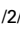
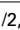
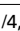
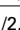
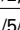
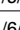
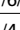
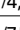
Type	Output stages [kW]	Airflow [m³/h]	Δt*1 [°C]	Sound level [dB(A)]	Voltage [V]	Amperage [A]	Length [mm]	Weight [kg]
AC203	0/  /1,5/3	900/1200	10/8	42/51	400V3N~*2	4,7	985	15,5
AC203C	0/  /2/3	900/1200	10/8	42/51	230V~	13,4	985	15,5
AC206	0/  /2,8/5,5	900/1200	19/14	42/51	400V3N~*2	8,3	985	15,5
AC209	0/  /4,5/9	900/1200	30/23	42/51	400V3N~*2	13,4	985	17,4
AC205	0/  /2,5/5	1400/1900	10/7	43/52	400V3N~*2	7,8	1500	21
AC210	0/  /5/10	1400/1900	21/15	43/52	400V3N~*2	15,1	1500	27
AC212	0/  /6/12	1400/1900	26/19	43/52	400V3~+230V~*2	17,9	1500	27
AC209XL	0/  /4,5/9	1800/2400	15/11	45/54	400V3N~*2.*3	13,8	1945	31
AC215XL	0/  /7,5/15	1800/2400	25/19	45/54	400V3~+230V~*2.*3	22,5	1945	35

\*1) Δt = temperature rise of passing air at maximum heat output and lowest/highest airflow.

\*2) Respectively 400V3~ + 230V~ if the amperage is above 16 A

\*3) A separate supply is needed for heating and fan circuits.

Protection class AC 200 with electrical heat: (IP21), drip-proof design.

For water heated versions see [www.frico.se](http://www.frico.se)



Suspension from the ceiling by drop-rod.

Dimensions

**AC201, AC203, AC203C, AC206, AC209  
(AC202, AC205, AC210, AC212)**

**From the top**

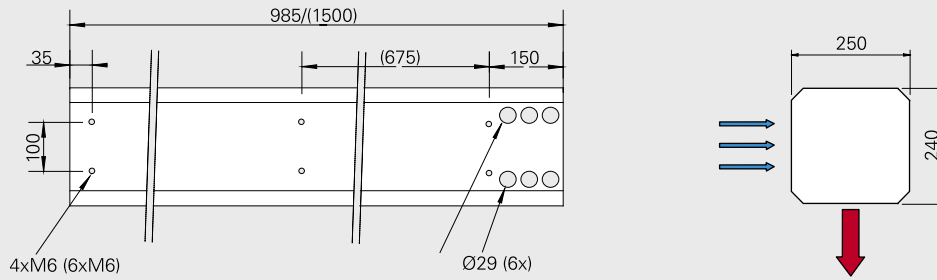

**Back view**

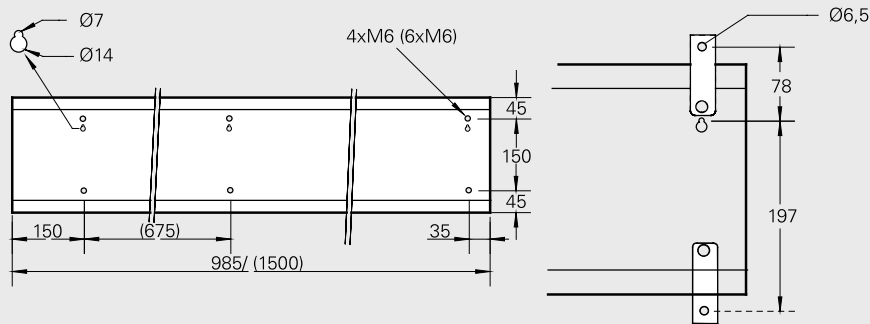

**AC202XL, AC209XL, AC215XL**

**From the top**

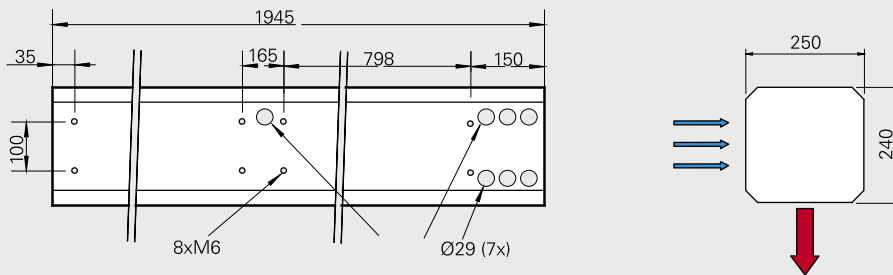

**Back view**

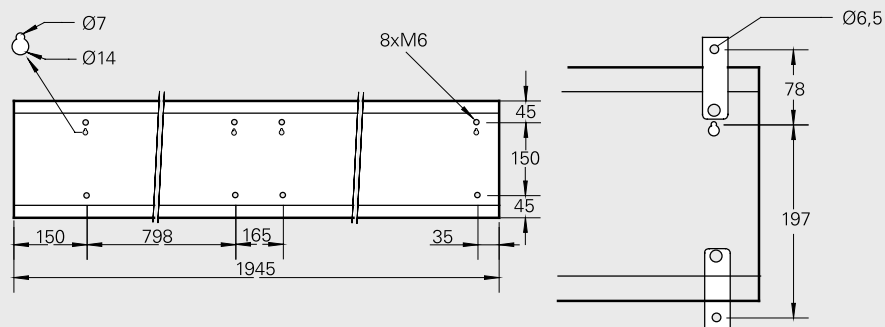

## Positioning, mounting and installation

### Mounting

Thermostone AC200 can be permanently mounted on the wall. The units may also be suspended from the ceiling by rod or other suitable device. They can also be mounted in false ceilings. The units must always be mounted in horizontal position, with the discharge grille facing down.

For minimum mounting distance to doorway, see Fig. 1 for the electrically heated models. When mounting in false ceilings, see Fig. 2. The 1,5 and 2 meters units should be fitted using three fixing points.

For maximum performance the units should cover the whole width of the opening and be fitted as close to the opening as possible. Several units can be mounted next to each other to form a continuous air curtain.

### Connection AC 200 ⚡

The appliance should be preceded by a triple pole switch with at least 3 mm breaking gap. Connection is made with a cable of type S05VV-U, A05VV-R or similar, through knock outs on the top of the unit (6 x Ø29 mm). For connection to the supply terminal block, a cable of maximum 16 mm<sup>2</sup> is used. For connection to the control terminal block, a cable of maximum 6 mm<sup>2</sup> is used. For units with electrical heating, power and voltage should be supplied in different connection areas. For smaller units common electrical supply exists for both heating and fan circuits.

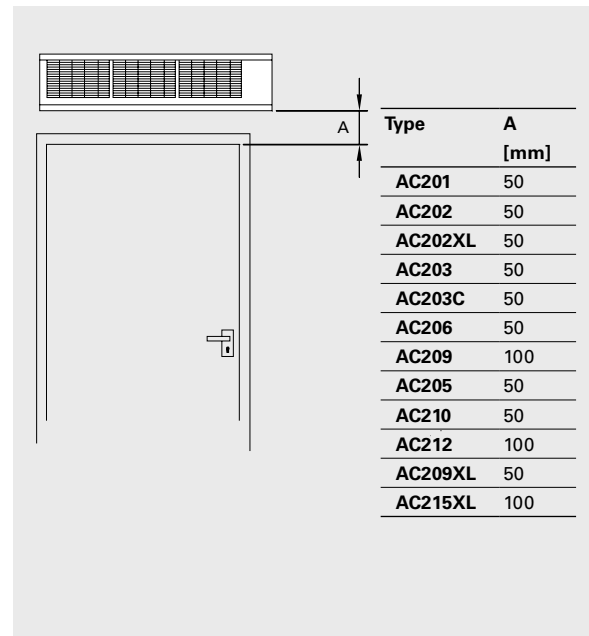

Fig. 1: AC200 with electrical heat, minimum distance above opening



Mounting in a false ceiling

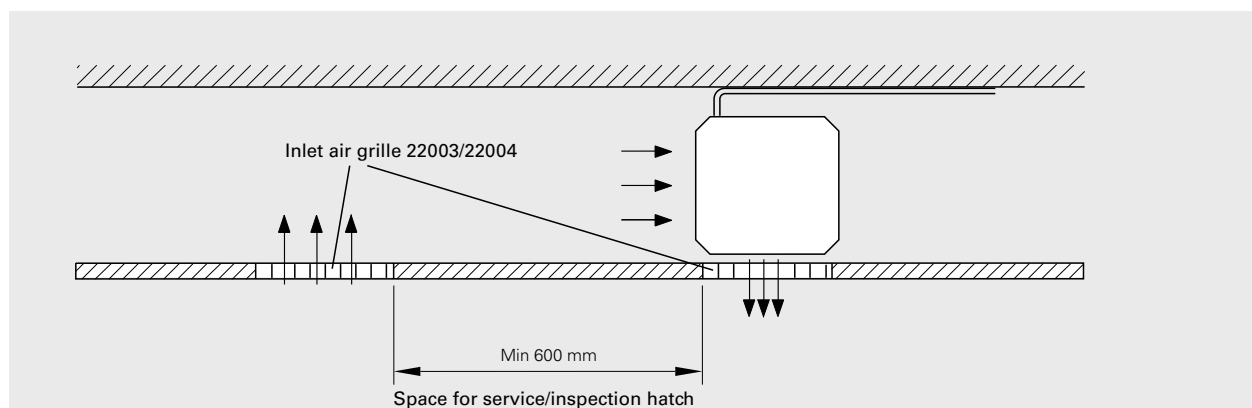

Fig. 2: Mounting in false ceiling

**Regulation kits**

**Ambient**

Airflow is regulated manually.

Complete regulation kit:

- CB20, control box, controls the airflow in 2 stages (option ACR20, for internal mounting)

**Electric**

Airflow is regulated manually. Room thermostat controls the heat output in 2 stages.

Complete regulation kit:

- CB22, control box, controls the airflow in 2 stages and heat output in 2 stages (option ACR22, 22007, for internal mounting)
- KRT2800, 2-stage thermostat (option RTI2)



Mounting next to each other to cover different door widths.

**Wiring diagrams AC 200**

**Ambient regulation options**

**High/low fan speed with control box CB20**

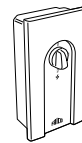
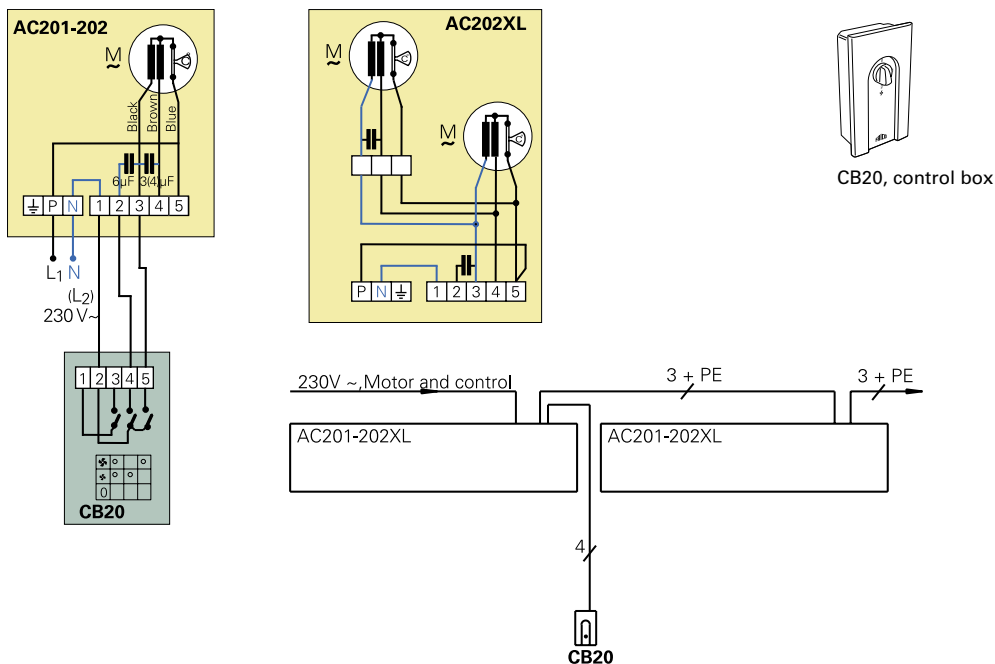

CB20, control box